

NOTES:
1. MATERIAL: ABS UL 94V-0

REVISIONS				
ZONE	REV	DESCRIPTION	DATE	APPROVED
	A	A-SEP-08 SMK-6	SEPT '08	

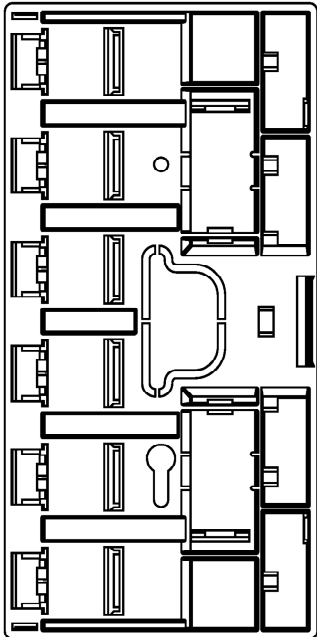
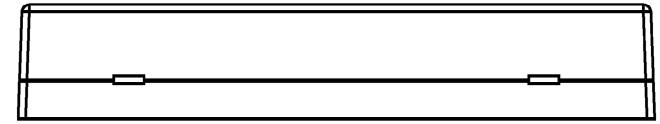
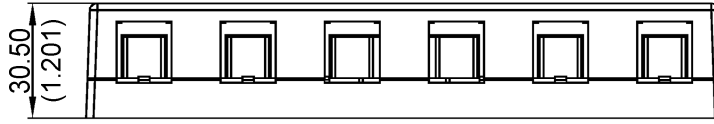
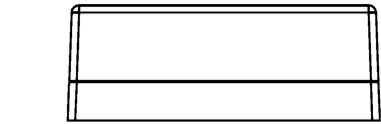
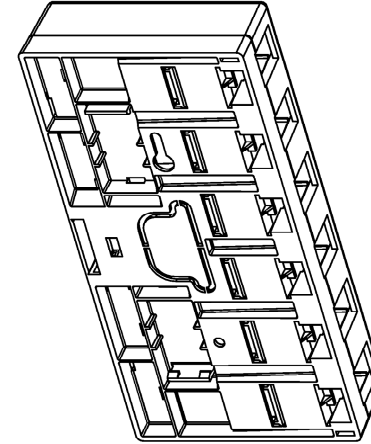
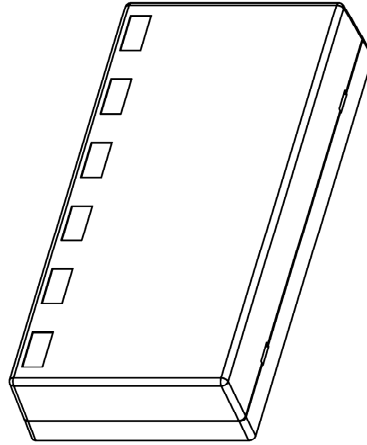

UNLESS OTHERWISE SPECIFIED
DIMENSIONS ARE IN MILLIMETERS (INCHES)
TOLERANCES:
MM IN ANGULAR
.X ± .2 .X ± .016 X ± 1°
.XX ± .1 .XX ± .008 .X ± .5°
.XXX ± .004

MATERIAL: AS NOTES



PROJECT ID SPCS - PD		FILE SPCS - PD.KSM-MMB.SMKL6	SEPT '08	16295 NW 13th Ave, Ste A, Miami, FL 33169, PH: (305) 944-7710, FX: (305) 949-4483, www.signamax.com	
PROCESS	INITIALS	NAME	DATE	TITLE	
DRAWN				SMKL-6 (6-PORT SURFACE MOUNT BOX)	
CHECK				SIZE	REV
APPROVED				A	A
				CAGE CODE	DWG. NO.
				SCALE	SHEET
				1:2	1 OF 1
				UNIT MM (IN)	