

Features:

- Capacity: CU/AL 4/0 to 750MCM
 - Telescoping handle to 11.25"
 - Ratchet mechanism for easy cutting
 - Contoured plastic handle with ergonomic thumb guards
- Safety lock
 - Replaceable blades
 - Quick release blade return during cutting

How to cut cable:

1. Position the UpperCut I with the safety lock/unlock knob (4) facing toward you.
2. Release lock/unlock knob (4). Squeeze tool handles together (5), then rotate lock/unlock knob (4) counter clockwise to the “ON” position.
3. Fully open handle (5) until it stops (handle will engage internal cam).
4. Rotate movable blade (1) counter clockwise until it is free of the fixed blade (2), then push release switch (3).
5. Place cable to be cut against the fixed blade (2) and rotate movable blade (1) counter clockwise (listening for ratchet sounds) until it is snug against the cable, then release switch (3).
6. Squeeze the handles together repeatedly until cable is cut.
7. To release cable before cut is complete:
 - a. Slightly squeeze handles (5) together to relieve some blade tension, then pull down blade release switch (3) until it disengages movable blade (1).
 - b. Open handle (5) until it stops and rotate blade (1) clockwise until cable is released.
8. For maximum cutting power extend the telescoping handles:
 - a. Firmly grasp both handles (5) and blade pivot bolt (6).
 - b. Pull one handle at a time away from the blades, handles will extend and additional 2.25”.



WARNING

Blades are sharp. Keep hands and fingers away from blades when extending the telescoping handles.

NOTE: When cutting cable, the blades should be perpendicular to the cable to avoid unnecessary “side load” to the blades.

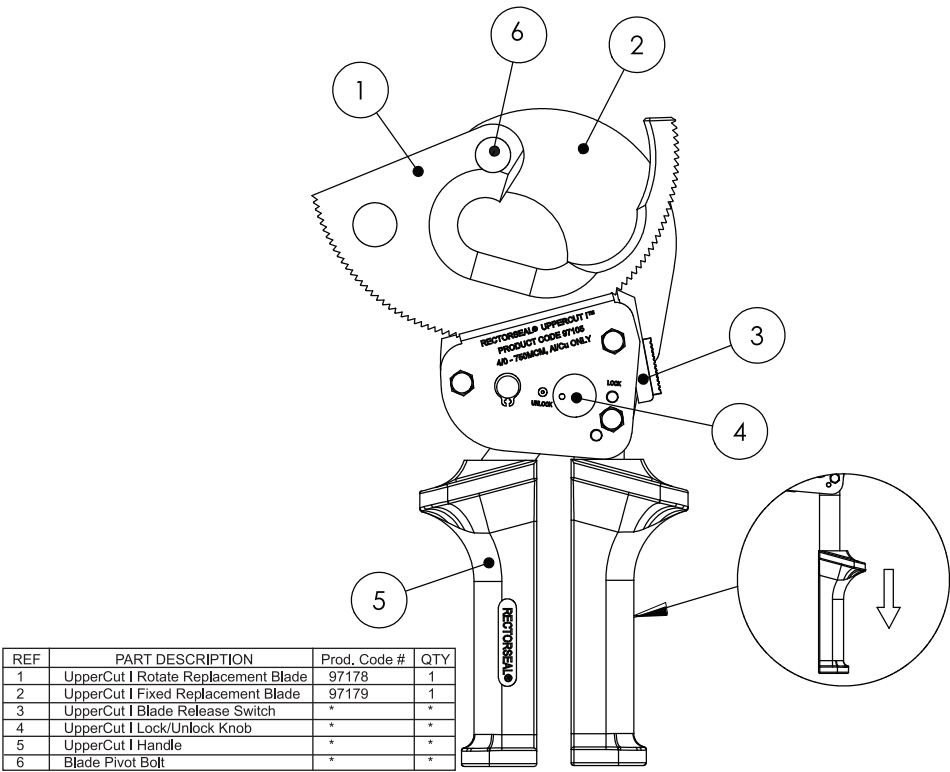

REF	PART DESCRIPTION	Prod. Code #	QTY
1	UpperCut I Rotate Replacement Blade	97178	1
2	UpperCut I Fixed Replacement Blade	97179	1
3	UpperCut I Blade Release Switch	*	*
4	UpperCut I Lock/Unlock Knob	*	*
5	UpperCut I Handle	*	*
6	Blade Pivot Bolt	*	*



DANGER

Never use on or near live electrical circuits.



WARNING

Always wear safety glasses when cutting.



Product Code 97105

RectorSeal
2601 Spenwick Dr.
Houston, TX 77055, USA
713/263-8001 or 800/231-3345
www.rectorseal.com

