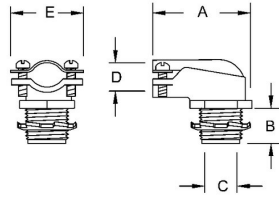

AC CABLE 90 DEGREE SQUEEZE TYPE

90° Squeeze Connectors, Insulated Throat Malleable Iron
N/A

B69

Catalog #: 3202

APPLICATIONS

For use in dry locations to bond flexible metal conduit to a box or enclosure
N/A
For use in dry locations to bond armored cable to a box or enclosure

PRODUCT FEATURES

All malleable iron construction insures mechanical protection for the raceway
Electro zinc plated for added corrosion protection
UPC bar coded fittings are individually polybagged with a preprinted UPC-A bar code, and packaged in pre-scored tear top cartons for an attractive presentation

CULUS

UL Listed E195969

GENERAL PRODUCT INFORMATION

Sub Class: Insulated
Trade Size: 1/2 in.

DRAWING DIMENSIONS

Dimension A: 2-15/64 in.
Dimension B: 27/64 in.
Thread Spec. B: 1/2 in. - 14 NPS
Dimension C: .570 in.
Dimension D: .817-.950 in.
Dimension E: 1-51/64 in.

PACKAGING

Package Type: Carton
Ship Carton Qty.: 25
Product UPC-A Labeled: No
Weight (Lbs. Per/C): 10.70
Ship Carton Length (in.): 8.25
Ship Carton Width (in.): 5.00
Ship Carton Height (in.): 4.00
Ctn Weight (Lbs.): 2.68
UPC Number: 050169032022
I2of5: 50050169032027