



Core & Coil (71A) LPS

CORE & COIL HID LPS BAL 90W L72 QUAD C&C

The basic ballast is the open core and coil which is most often used as a component within a lighting luminaire. The core and coil also forms the nucleus of Philips Advance's five other ballast configurations.

Product data

General Information	
ANSI Code	L72
Lamp Type	90W LPS
Number of Lamps	1 piece/unit
Circuit Type	HX-HPF
Ballast Type	Magnetic HID
Base Model	71A0590
Core Size	4 1/4 x 4 3/4 (2 coil)
Suitable For Outdoor Use	Yes
Capacitor Value	17.5 MFD
Capacitor Catalog Number	7C175M30RA
Capacitor Requirements	300V
Capacitor Temperature Rating	105°C
Capacitor Diameter/Oval Dimensions	1.65 in
Capacitor Height	3.7 in
Automatic Restart	No

Operating and Electrical	
Input Voltage	120/208/240/277 V
Input Frequency	60 Hz
Input Current (Open Circuit)	4.1/2.3/2/1.75 A
Input Current (Starting)	1.15/0.65/0.6/0.52 A
Input Current (Short Circuit)	0.32-0.48/0.17-0.26/0.16-0.24/0.13-0.2 A
Secondary Short Circuit Current	0.9-1.1 A

Constant Wattage Deviation	10%
Ballast Factor (Nom)	1
Power Factor (Nom)	0.90
Open Circuit Voltage	515 V
Input Current (Nom)	1.06/0.6/0.53/0.5 A A
Input Power (Nom)	125 W
Rated Lamp Power	90 W

Wiring	
Wire Striplength	0.5 mm
Wire Length by Color	12"
Wire Type	Stranded
Remote Wiring Configuration Allowed	Yes
Max Ballast-Lamp Distance Remote	Determined by AWG used
Wiring	
Recommended Fuse Value	11/6/5/5 A

Approval and Application	
Open Circuit Voltage Test (Volts)	460-565 V
Approval Marks	ULR CSA certificate RoHS Compliant
Temperature Marking	A/A/A/A
UL Recognized	Yes
Hipot Test (1 Minute)	2000 V
Hipot Test (2 Seconds)	2500 V

Core & Coil (71A) LPS

UL Insulation Class	H(180°C)
UL Temperature Code	1029A
Product Data	
Order product name	CORE & COIL HID LPS BAL 90W L72 QUAD C&C
EAN/UPC - Product	781087120019
Order code	913700502061

Numerator - Quantity Per Pack	1
Numerator - Packs per outer box	4
Material Nr. (12NC)	913700502061
Net Weight (Piece)	4.623 kg

Dimensional drawing

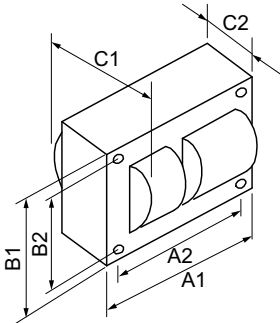

LPS BAL 90W L72 QUAD C&C

Product	C1	C2	A1	A2	B1	B2
CORE & COIL HID LPS BAL 90W L72 QUAD C&C	3.25 in	2.25 in	4.8 in	4.4 in	4.3 in	3.9 in

