

REMOVABLE CAP
TO TIGHTEN SCREW
(REPLACE WHEN COMPLETE)

5/16" INTERNAL HEX
PRESSURE SCREW

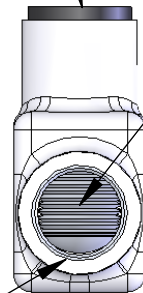

WIRE ENTRY POINT
WIRE RANGE: 600 KCMIL - #6 AWG
PRE-FILLED W/ OXIDE INHIBITOR

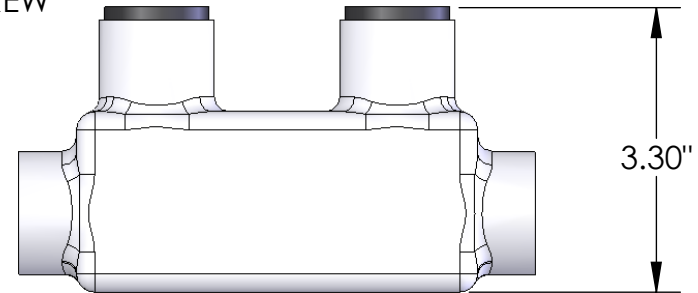

NOTES:

1. CONNECTOR MANUFACTURED FROM 6061-T6 ALUMINUM ALLOY.
2. UL LISTED PER UL486A/B SPECIFICATIONS FOR 600V.
3. DUAL RATED FOR 90°C COPPER AND/OR ALUMINUM CONDUCTOR.
4. COLD TEMPERATURE RATED TO -45°C.
5. HIGH DIELECTRIC STRENGTH INSULATION IS ABRASION AND CHEMICAL RESISTANT
6. UV RATED

		POLARIS SALES . CO . INC					
<small>PROPRIETARY AND CONFIDENTIAL</small>		<small>11625 PROSPEROUS DRIVE ODESSA, FL 33556</small>					
<small>THE INFORMATION CONTAINED IN THIS DRAWING IS THE SOLE PROPERTY OF POLARIS SALES CO. INC. ANY REPRODUCTION IN PART OR AS A WHOLE WITHOUT THE WRITTEN PERMISSION OF POLARIS SALES CO. INC. IS PROHIBITED.</small>		TITLE: INSULATED 600 SPLICE CONNECTOR					
<table border="1"> <thead> <tr> <th>NAME</th> <th>DATE</th> </tr> </thead> <tbody> <tr> <td>L. HILL</td> <td>07-23-10</td> </tr> </tbody> </table>		NAME	DATE	L. HILL	07-23-10	DWG. NO. ISR600	
NAME	DATE						
L. HILL	07-23-10						
MATERIAL: N/A		SCALE: N/A	SHEET: 1 OF 1				