



# TRAC-MASTER®

Avant Garde

## FRONT LAMPING OPEN BACK SPOTLIGHTS

### T687, T689 and T690

Project: \_\_\_\_\_

Fixture Type: \_\_\_\_\_

Location: \_\_\_\_\_

Contact/Phone: \_\_\_\_\_

#### PRODUCT DESCRIPTION

The clean, functional lines of the open back allows maximum adjustability. Front Loading Open Back Spotlights relamp from the front and have fixed socket mount and on/off switch. The minimum profile with stylized yoke design is ideal for retail and commercial applications.

**Construction** Die formed steel.

**Socket** Medium base porcelain with nickel plated copper screw shell.

**Aiming** 90° vertical aiming capability and 358° rotation.

**Juno Universal Trac Adapter** Universally compatible with both Trac-Master 1-circuit or 2-circuit trac, Trac-Lites trac, monopoints and special mountings • Also UL Recognized for use on ConTech® LT Series track • Copper alloy contacts provide precise spring action - no arcing and will not take a set • True, positive electrical ground • On/off switch included • Patented embossed polarity arrows on bottom of adapter • Spring-loaded positive latch with embossed polarity arrows secures trac light to trac • Two-position power contact provided for two-circuit application.

**Alternate TEK Trac Adapter** Compatible with Juno TEK trac system • System specific and assembled to trac fixture • Integrally polarized construction to prevent reverse installation – only allows insertion in proper orientation • Rotary circuit selector enables simple switching between circuits • Integral on/off switch enables individual fixtures to be switched for servicing.

**Alternate GTYPE Trac Adapter** Compatible with track systems based on GES type track, including Lithonia LT Commercial Track (not LTS type) • System specific and assembled to trac fixture • Two-position power contact provided for two-circuit application • Consult factory for additional information.

**Alternate HTYPE Trac Adapter** Compatible with track systems which use a H-type track adapter, including Lithonia LTS Decorative Track (not LT type) • System specific and assembled to trac fixture • Two-position power contact provided for two-circuit application • Consult factory for additional information.

**Alternate LTYPE Trac Adapter** Compatible with track systems which use a L-type track adapter • System specific and assembled to trac fixture • Two-position power contact provided for two-circuit application • Consult factory for additional information.

**Labels** UL Listed • CSA Certified.

Specifications subject to change without notice.



#### Line Voltage PAR20

Catalog Number	Description	Finish	Lamp
T687 WH	Open Back w/Universal Trac Adapter	White	50W PAR20
T687 BL	Open Back w/Universal Trac Adapter	Black	50W PAR20
T687 GTYPE WH	Open Back w/G-Type Trac Adapter	White	50W PAR20
T687 GTYPE BL	Open Back w/G-Type Trac Adapter	Black	50W PAR20
T687 HTYPE WH	Open Back w/H-Type Trac Adapter	White	50W PAR20
T687 HTYPE BL	Open Back w/H-Type Trac Adapter	Black	50W PAR20
T687 LTYPE WH	Open Back w/L-Type Trac Adapter	White	50W PAR20
T687 LTYPE BL	Open Back w/L-Type Trac Adapter	Black	50W PAR20

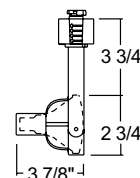

ConTech is a registered trademark of ConTech Lighting.



One Lithonia Way • Conyers, GA 30012 • Phone (847) 827-9880 • Fax (847) 827-2925 • Visit us at [www.acuitybrands.com](http://www.acuitybrands.com)  
Printed in U.S.A. ©2017-2019 Acuity Brands Lighting, Inc. Rev. 10/11/19

**TRAC-MASTER®**

Avant Garde

**FRONT LAMPING  
OPEN BACK SPOTLIGHTS****T687, T689 and T690****Line Voltage PAR30**

Catalog Number	Description	Finish	Lamp
<b>T689 WH</b>	Open Back w/Universal Trac Adapter	White	75W PAR30
<b>T689 BL</b>	Open Back w/Universal Trac Adapter	Black	75W PAR30
<b>T689 NAT</b>	Open Back w/Universal Trac Adapter	Natural	75W PAR30
<b>T689 GTYPE WH</b>	Open Back w/G-Type Trac Adapter	White	75W PAR30
<b>T689 GTYPE BL</b>	Open Back w/G-Type Trac Adapter	Black	75W PAR30
<b>T689 GTYPE NAT</b>	Open Back w/G-Type Trac Adapter	Natural	75W PAR30
<b>T689 HTYPE WH</b>	Open Back w/H-Type Trac Adapter	White	75W PAR30
<b>T689 HTYPE BL</b>	Open Back w/H-Type Trac Adapter	Black	75W PAR30
<b>T689 HTYPE NAT</b>	Open Back w/H-Type Trac Adapter	Natural	75W PAR30
<b>T689 LTYPE WH</b>	Open Back w/L-Type Trac Adapter	White	75W PAR30
<b>T689 LTYPE BL</b>	Open Back w/L-Type Trac Adapter	Black	75W PAR30
<b>T689 LTYPE NAT</b>	Open Back w/L-Type Trac Adapter	Natural	75W PAR30

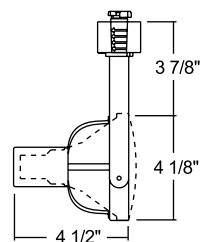
**Line Voltage PAR38**

Catalog Number	Description	Finish	Lamp
<b>T690 WH</b>	Open Back w/Universal Trac Adapter	White	250W PAR38
<b>T690 BL</b>	Open Back w/Universal Trac Adapter	Black	250W PAR38
<b>T690 SL</b>	Open Back w/Universal Trac Adapter	Silver	250W PAR38
<b>T690 TEK WH</b>	Open Back w/TEK Trac Adapter	White	250W PAR38
<b>T690 TEK BL</b>	Open Back w/TEK Trac Adapter	Black	250W PAR38
<b>T690 TEK SL</b>	Open Back w/TEK Trac Adapter	Silver	250W PAR38
<b>T690 GTYPE WH</b>	Open Back w/G-Type Trac Adapter	White	250W PAR38
<b>T690 GTYPE BL</b>	Open Back w/G-Type Trac Adapter	Black	250W PAR38
<b>T690 GTYPE SL</b>	Open Back w/G-Type Trac Adapter	Silver	250W PAR38
<b>T690 HTYPE WH</b>	Open Back w/H-Type Trac Adapter	White	250W PAR38
<b>T690 HTYPE BL</b>	Open Back w/H-Type Trac Adapter	Black	250W PAR38
<b>T690 HTYPE SL</b>	Open Back w/H-Type Trac Adapter	Silver	250W PAR38
<b>T690 LTYPE WH</b>	Open Back w/L-Type Trac Adapter	White	250W PAR38
<b>T690 LTYPE BL</b>	Open Back w/L-Type Trac Adapter	Black	250W PAR38
<b>T690 LTYPE SL</b>	Open Back w/L-Type Trac Adapter	Silver	250W PAR38

