



TRAC-MASTER®

Avant Garde

OPEN BACK SPOTLIGHTS

T696, T362, T363 and T368

Project: _____

Fixture Type: _____

Location: _____

Contact/Phone: _____

PRODUCT DESCRIPTION

The clean, functional lines of the open back allows maximum adjustability. Open Back Spotlights relamp from back and have floating socket mount and on/off switch. The minimum profile with stylized yoke design is ideal for retail and commercial applications.

Construction Die formed steel.

Aiming 90° vertical aiming capability and 358° rotation.

Labels UL listed, CSA certified.

Specifications subject to change without notice.



Low Voltage MR16

Lamp 12V, 60W maximum MR16 GU5.3/GX5.3 bi-pin.

Socket Ceramic bi-pin.

Transformer Must be ordered separately • Compatible with T537 universal 12V electronic transformer for LED or halogen lamps ([T537](#) [T537Q](#)).

Catalog Number	Finish	Lamp
T696 WH	White	60W MR16 max.
T696 BL	Black	60W MR16 max.

ACCESSORIES

Cat. No.	Description	Cat. No.	Description
CGF 175	Color Glass Filter	HCLBL 175	Hexagonal Cell Louver - Black
DCCF 175	Dichroic Color Correction Filter	DIFF 175	Diffusion Glass Lens
DGF 175	Dichroic Glass Filter	UVF 175	UV Filter
SOLITE 175	Uniformity Lens (Solite)	LSPREAD 175	Linear Spread Glass Lens
PRISM 175	Prismatic Spread Glass Lens		

See specification sheet [D1.2.2](#) for details. Other accessories can be found on specification sheet [D1.2.0](#).

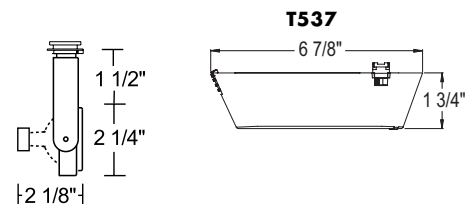

TRAC-MASTER®

Avant Garde

OPEN BACK SPOTLIGHTS**T696, T362, T363 and T368****Line Voltage PAR20****Lamp** 120V, 50W maximum PAR20 medium base.**Socket** Medium base porcelain with nickel plated copper screw shell.**Juno Universal Trac Adapter** Compatible with Juno Trac-Master 1 or 2-circuit systems or Juno Trac-Lites system • Copper alloy contacts provide precise spring action - no arcing and will not take a set • True, positive electrical ground • On/off switch included • Patented embossed polarity arrows on bottom of adapter • Spring-loaded positive latch with embossed polarity arrows secures trac light to trac • Two-position power contact provided for two-circuit application.**Alternate TEK Trac Adapter** Compatible with Juno TEK trac system • System specific and assembled to trac fixture • Integrally polarized construction to prevent reverse installation – only allows insertion in proper orientation • Rotary circuit selector enables simple switching between circuits • Integral on/off switch enables individual fixtures to be switched for servicing.

Catalog Number	Description	Finish	Lamp
T362 WH	Open Back w/Universal Trac Adapter	White	50W PAR20 max.
T362 BL	Open Back w/Universal Trac Adapter	Black	50W PAR20 max.
T362 SC	Open Back w/Universal Trac Adapter	Satin Chrome	50W PAR20 max.

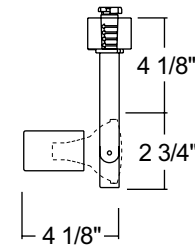
Other accessories can be found on specification sheet [D1.2.0](#).**Line Voltage PAR30****Lamp** 120V, 75W maximum PAR30 medium base.**Socket** Medium base porcelain with nickel plated copper screw shell.**Adapters** Refer to **T362**.

Catalog Number	Description	Finish	Lamp
T363 WH	Open Back w/Universal Trac Adapter	White	75W PAR30 max.
T363 BL	Open Back w/Universal Trac Adapter	Black	75W PAR30 max.
T363 TEK WH	Open Back w/TEK Trac Adapter	White	75W PAR30 max.
T363 TEK BL	Open Back w/TEK Trac Adapter	Black	75W PAR30 max.

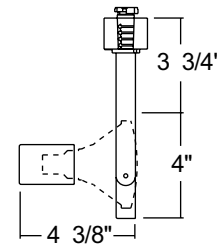
Other accessories can be found on specification sheet [D1.2.0](#).**Line Voltage PAR38****Lamp** 120V, 150W maximum PAR38 medium base.**Socket** Medium base porcelain with nickel plated copper screw shell.**Adapters** Refer to **T362**.

Catalog Number	Description	Finish	Lamp
T368 WH	Open Back w/Universal Trac Adapter	White	150W PAR38 max.
T368 BL	Open Back w/Universal Trac Adapter	Black	150W PAR38 max.
T368 NAT	Open Back w/Universal Trac Adapter	Natural	150W PAR38 max.

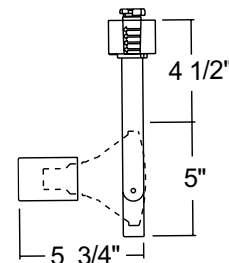
**ACCESSORIES**

Cat. No.	Description	Cat. No.	Description
HCLBL 469	Hexcell Louver - Black	UVF 469	UV Filter
CCLBL 469	Cube Cell Louver - Black	DIFF 469	Diffusion Glass Lens
SNOOTBL 469	Snoot - Black	SOLITE 469	Uniformity Lens (Solite)
CGF 469	Color Glass Filter	PRISM 469	Prismatic Spread Glass Lens
DGF 469	Dichroic Glass Filter	LSPREAD 469	Linear Spread Glass Lens
DCCF 469	Dichroic Color Correction Filter	T40N¹	Monopoint

See specification sheet [D1.2.2](#) for details. Other accessories can be found on specification sheet [D1.2.0](#).

Notes:

1 Add finish code to complete catalog number (Example: T40N WH).