

## FEATURES & SPECIFICATIONS

**INTENDED USE** — Ideal for a wide variety of low- to medium-height ceiling applications including commercial, retail and hospitality spaces where a baffled fixture is required.

**CONSTRUCTION** — Heavy gauge die formed galvanized steel mounting frame with mechanical trim retention (yoke) ensures secure and flush reflector mounting to ceiling. Attached to frame are vertically adjustable mounting brackets for use with C channels, ½" steel conduit or 16 gauge flat bar hangers included, standard. Frames equipped with galvanized junction box UL Listed for through wire applications. Junction boxes equipped with (2) ¾" and (4) ½" conduit knockouts with pryout slots and removable access doors.

Maximum 1-1/2" ceiling thickness.

**OPTICS** — Aluminum full reflectors are optically designed to maximize lumen output and to provide superior glare control. The black or white baffled reflectors have a semi-specular upper finish with a white painted flange standard.

**ELECTRICAL** — Electronic ballast with end of lamp life protection standard. Class P thermally protected ballast protects against improper contact with insulation. Minimum starting temperature is 0°F-18°C.

Rated for #12 AWG conductor thru-branch wiring. Minimum 90° supply wire.

Ground wire provided.

Lamp Socket Base:

TRT 4-pin lamps – 26W (GX24Q-3); 32W (GX24Q-3); 42W (GX24Q-4)

**LISTINGS** — Fixtures are UL Listed for thru-branch wiring, Non-IC recessed mounting, damp location, and to U.S. and Canadian Safety Standards.

**WARRANTY** — 1-year limited warranty. Complete warranty terms located at [www.acuitybrands.com/CustomerResources/Terms\\_and\\_conditions.aspx](http://www.acuitybrands.com/CustomerResources/Terms_and_conditions.aspx)

Note: Specifications subject to change without notice.

Catalog Number
Notes
Type

### Compact Fluorescent Downlighting

# 8" LF8N



#### BAFFLE

Horizontal 2-Lamp, Triple Tube (TRT)

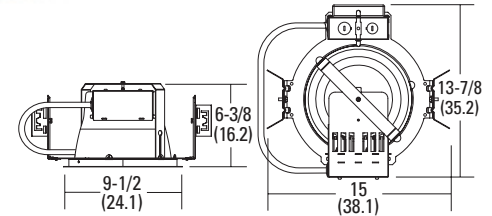

#### Specifications

Max. height: 6-3/8 (16.2)

Ceiling opening: 8-3/4 (22.2)

Overlap trim: 9-1/2 (24.1)

Length: 15 (38.1)

Width: 13-7/8 (35.2)

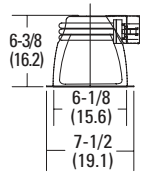

All dimensions are inches (centimeters) unless otherwise indicated.

#### ORDERING INFORMATION

For shortest lead times, configure product using **bolded options**.

**Example:** LF8N 2/26-42TRT F8B4 MVOLT

LF8N	Series	Wattage/Lamp	Reflector/Color <sup>2</sup>	Voltage	Options <sup>5</sup>
	<b>LF8N</b>	<b>2/26-42TRT<sup>1</sup></b> 2/26TRT 2/32TRT 2/42TRT	<b>F8B4</b> Black baffle <b>F8B4W</b> White baffle	<b>MVOLT<sup>3</sup></b> 120 277 347 <sup>4</sup>	<b>ADEZ</b> Advance Mark 10™ electronic dimming ballast, 120V or 277V. Must be wattage and voltage specific. Minimum dimming level 5% <b>ECOS</b> Lutron EcoSystem electronic dimming ballast, 120V - 277V. Must be wattage specific. Minimum dimming level 5% <b>EL</b> Emergency PSDL3 DL battery pack with integral test switch <sup>6</sup> <b>ELR</b> Emergency PSDL3 DL battery pack with remote test switch <sup>6</sup> <b>ELRHL2LP</b> Iota I-162 Emergency battery pack with remote test switch. Operates two 26W, two 32W or two 42W CFL lamps in emergency mode with battery back-up in case of power disruption. Average output is 2600 lumens for two 26W lamps; average output is 2750 lumens for two 32W lamps; average output is 2800 lumens for 42W lamps <sup>7</sup> <b>GMF</b> Single slow-blow fuse, must specify voltage <b>BDP</b> Ballast disconnect plug (meets codes that require in-fixture disconnect) <sup>4</sup> <b>WLP</b> 35K lamp (shipped separately) <b>RIF1</b> Radio interference filter <b>LBH</b> Less barhangers

**Accessories:** Order as separate catalog number.

SCA8	Sloped ceiling adaptor. Degree of slope must be specified (10D, 15D, 20D, 25D, 30D) Ex: SCA8 <b>10D</b> .
CTE8	Ceiling thickness extender is used when ceiling thickness is greater than 1-1/2 (3.8). Maximum thickness 2 (5.1).

#### Notes

- 1 Not available with ECOS or WLP.
- 2 White painted flange standard.
- 3 Electronic multi-volt ballast capable of operating any line voltage from 120-277V, 50 or 60Hz.
- 4 Not available with EL or ELR.
- 5 For additional options see [www.lithonia.com](http://www.lithonia.com).
- 6 Ships standard for 1-lamp operation. For 2-lamp emergency operation, consult installation instructions or factory. Add 3" (7.6) to width and 4-1/2" (11.4) to length.
- 7 Not recommended for field installation.

# 8" LF8N Horizontal 2-Lamp, Triple Tube (TRT), Baffle

## PHOTOMETRICS

Distribution Curve	Distribution Data	Output Data	Coefficient of Utilization	Illuminance Data at 30" Above Floor for a Single Luminaire
--------------------	-------------------	-------------	----------------------------	--

LF8N 2/26TRT F8B4 MVOLT, (2) 26W TRT lamps, 1.47 s/mh, 1800 rated lumens, test no. LTL12106

Vertical Angle	Intensity Distribution		Zonal Lumen Summary		ROR	Coefficients of Utilization							
	Horizontal Angle	0	Zone	Lumens		% Lamp	pf	80%		70%		50%	
								50%	30%	50%	30%	50%	30%
90°		0	0° - 30°	762.2	21.2	0	55	55	54	54	51	51	
80°		5	0° - 40°	1220.8	33.9	1	50	49	49	48	48	47	
70°		15	0° - 60°	1650.5	45.8	2	46	44	45	43	44	42	
60°		25	0° - 90°	1664.6	46.2	3	42	39	41	39	40	38	
50°		35	90° - 180°	0.0	0.0	4	38	35	38	35	37	34	
40°		45	0° - 180°	1664.6	*46.2	5	35	32	35	32	34	31	
30°		55			*Total Efficiency	6	32	29	32	29	31	28	
		65				7	30	26	29	26	29	26	
		75				8	27	24	27	24	26	24	
		85				9	25	22	25	22	25	22	
		90				10	24	20	23	20	23	20	

LF8N 2/32TRT F8B4 MVOLT, (2) 32W TRT lamps, 1.43 s/mh, 2400 rated lumens, test no. LTL12110

Vertical Angle	Intensity Distribution		Zonal Lumen Summary		ROR	Coefficients of Utilization							
	Horizontal Angle	0	Zone	Lumens		% Lamp	pf	80%		70%		50%	
								50%	30%	50%	30%	50%	30%
90°		0	0° - 30°	947.1	19.7	0	51	51	50	50	47	47	
80°		5	0° - 40°	1504.9	31.4	1	47	45	46	44	44	43	
70°		15	0° - 60°	2029.5	42.3	2	42	40	42	40	40	39	
60°		25	0° - 90°	2046.0	42.6	3	39	36	38	36	37	35	
50°		35	90° - 180°	0.0	0.0	4	35	33	35	32	34	32	
40°		45	0° - 180°	2046.0	*42.6	5	32	29	32	29	31	29	
30°		55			*Total Efficiency	6	30	27	29	27	29	26	
		65				7	27	24	27	24	26	24	
		75				8	25	22	25	22	25	22	
		85				9	23	20	23	20	23	20	
		90				10	22	19	22	19	21	19	

LF8N 2/42TRT F8B4 MVOLT, (2) 42W TRT lamps, 1.38 s/mh, 3200 rated lumens, test no. LTL12049

Vertical Angle	Intensity Distribution		Zonal Lumen Summary		ROR	Coefficients of Utilization							
	Horizontal Angle	0	Zone	Lumens		% Lamp	pf	80%		70%		50%	
								50%	30%	50%	30%	50%	30%
90°		0	0° - 30°	1181.5	18.5	0	48	48	46	46	44	44	
80°		5	0° - 40°	1867.6	29.2	1	44	42	43	42	41	40	
70°		15	0° - 60°	2536.7	39.6	2	40	38	39	37	38	36	
60°		25	0° - 90°	2557.6	40.0	3	36	34	36	34	35	33	
50°		35	90° - 180°	0.0	0.0	4	33	31	33	30	32	30	
40°		45	0° - 180°	2557.6	*40.0	5	30	28	30	27	29	27	
30°		55			*Total Efficiency	6	28	25	28	25	27	24	
		65				7	26	23	25	23	25	22	
		75				8	24	21	23	21	23	21	
		85				9	22	19	22	19	21	19	
		90				10	20	18	20	18	20	17	

### Notes

Energy (Calculated in accordance with NEMA Standard LE-5)

Actual performance may differ as a result of end-user environment and application.



LF8N-BAFFLE-2-TRT