



*Quality Products. Service Excellence.*

## Pedestal and Base 1495 Series



## Features

- Used for floor mounting for many types of enclosures, consolets or pushbutton boxes
- Provides wiring feature through the column.
- Meets NEMA Type 12 and 13 requirements.
- Finished in ANSI 61 gray.

## Pedestal Column

- Columns are formed from 14 gauge steel with 10 gauge flanges.
- Column access opening with gasketed cover.
- Columns include flange gaskets and a box connector.

## Pedestal Base

- Bases are formed from 10 gauge steel with additional reinforcing.
- Bases include levelling screws.

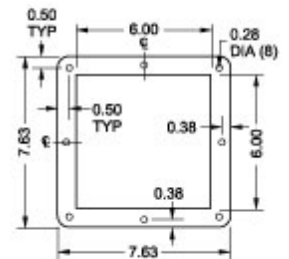
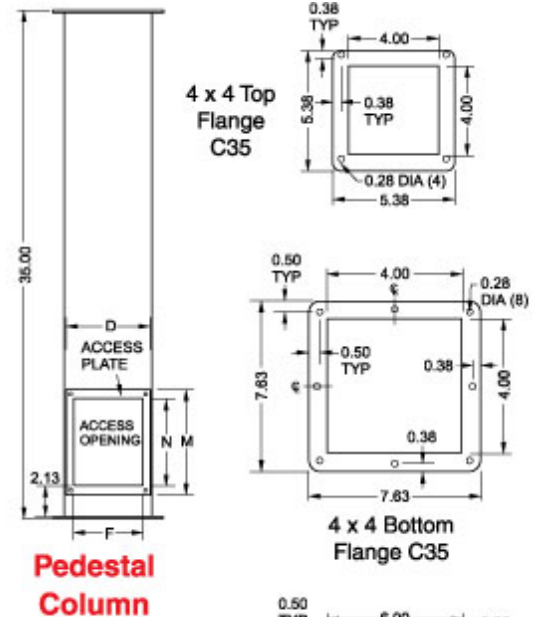
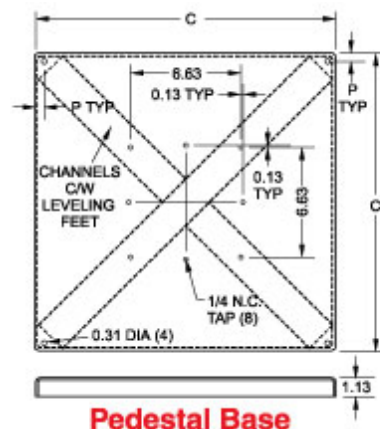

6 x 6 Top and Bottom Flange D35

Part No.	Description	C	D	F	M	N	P
1495C35	Straight Column	—	3.75	2.75	7.25	6.00	—
1495D35	Straight Column	—	5.75	4.75	7.25	6.00	—
1495XK	Pedestal Base	18.00	—	—	—	—	0.50

Part No.	Description	C	D	F	M	N	P
1495XN	Pedestal Base	24.00	—	—	—	—	0.50

*Data subject to change without notice*

© 2017. Hammond Manufacturing Ltd. All rights reserved.